

DMI

The universal diaphragm dosing pump

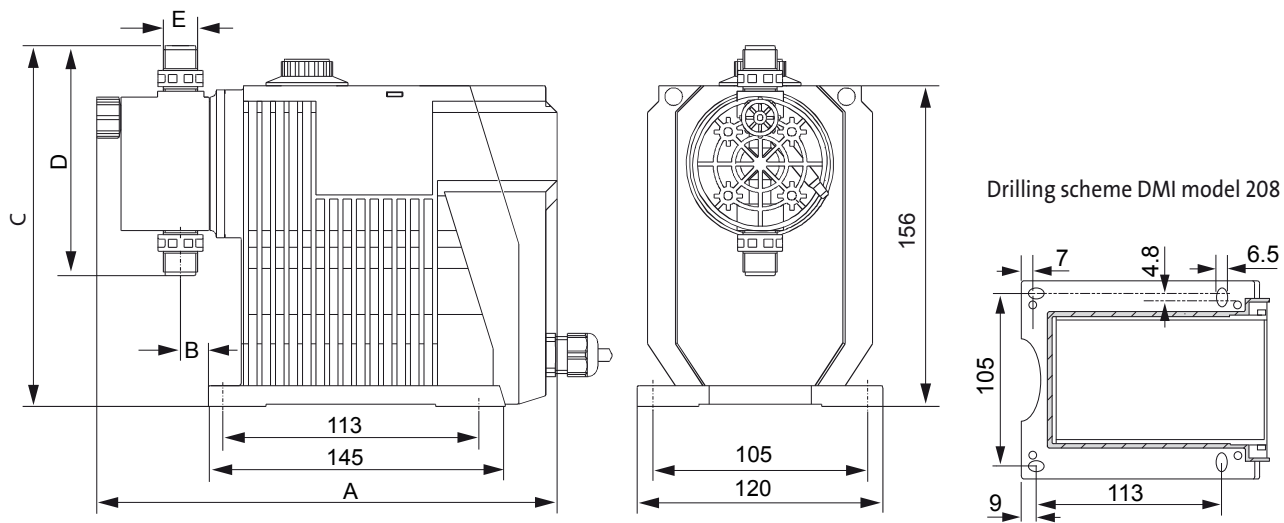

● DMI with manual deaeration



■ DMI with automatic deaeration

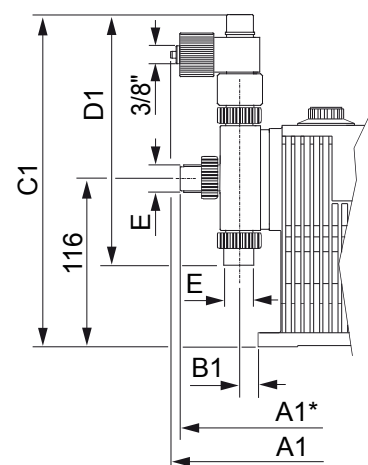

▲ DMI Inside

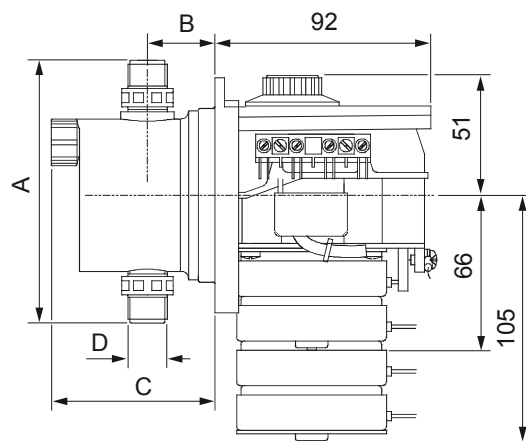

Drilling scheme DMI Inside

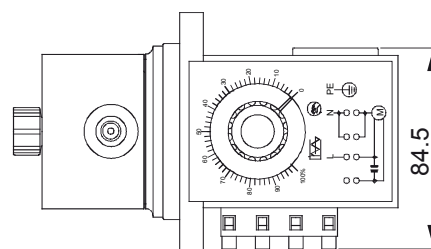
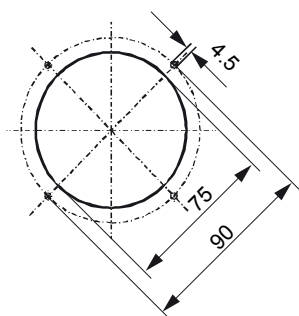

Measurements in mm

Measurements

DMI models	●	■	■	▲	●	■	▲	●	■	▲	●	■	●■
	A	A1	A1*	a	B	B1	b	C	C1	c	D	D1	E
208-0.3 (IN)	225	-	-	-	13.7	-	-	175.5	-	-	112	-	G 3/8"
208-0.8 (IN) to -1.1 (IN)	225	-	-	112	13.7	-	29	175.5	-	58	112	-	G 3/8"
208-1.6 (IN) to -3.0 (IN)	225	223	218	112	13.7	13.7	29	175.5	221.6	58	112	161	G 3/8"
208-3.6 (IN) to -6.0 (IN)	225	223	218	112	13.7	13.7	29	175.5	221.6	58	112	161	G 3/8"
208-9.0 (IN) to -18 (IN)	230	228.6	244	133	19.7	19.7	35	184.5	226.6	60	133	175	G 5/8"

Pump types

- Mains voltage 230 V ± 10 %, 50/60 Hz, with cable and Euro plug
- No electronics, manual stroke adjustment, strokes per minute: 120 at 50 Hz, 144 at 60 Hz
- Connections please see page 4

50 Hz		60 Hz				V _{stroke} [cm ³]	DMI models	
Q [l/h]	P _{max} [bar]	Q [l/h]	P _{max} [bar]	Q [USg/h]	P _{max} [psi]		208	208 Inside

Max. backpressure 10 bars at 50 Hz

0.3	10	0.36	10	0.095	145	0.04	208-0.3	
1.0	10	1.2	10	0.317	145	0.14	208-1.0	208-1.0 IN
1.6	10	1.92	10	0.507	145	0.22	208-1.6	208-1.6 IN
2.9	10	3.5	7	0.925	102	0.42	208-3.0	208-3.0 IN
4.0	8	4.8	6	1.270	87	0.55	208-4.0	208-4.0 IN
5.0	6	6	5	1.580	72.5	0.69	208-5.0	208-5.0 IN
6.0	8	7.2	6	1.902	87	0.84	208-6.0	208-6.0 IN
9.0	6	11	5.5	2.853	80	1.24	208-9.0	208-9.0 IN
14	4	16.8	3	4.439	44	1.92	208-14	208-14 IN
18	3.5	21.6	3	5.702	44	2.46	208-18	208-18 IN

Max. backpressure 16 bars at 50 Hz

0.8	16	0.96	16	0.254	232	0.13	208-0.8	208-0.8 IN
1.1	16	1.32	16	0.349	232	0.16	208-1.1	208-1.1 IN
3.6	16	4.32	13	1.140	189	0.50	208-3.6	208-3.6 IN

Max. backpressure 10 bars, with automatic deaeration, at 50 Hz

0.75	10	0.9	10	0.238	145	0.14	208-1.0	-
1.2	10	1.44	10	0.380	145	0.22	208-1.6	-
2.5	9	3.0	7	0.792	102	0.42	208-3.0	-
3.5	8	4.2	6	1.109	87	0.55	208-4.0	-
4.4	5	5.28	5	1.394	72.5	0.69	208-5.0	-
5.47	8	6.5	6	1.711	87	0.84	208-6.0	-
8.3	5	10	4	2.630	58	1.24	208-9.0	-
13.3	3	16	3	4.213	44	1.92	208-14	-
17	2.5	20.40	2	5.386	29	2.46	208-18	-



DMI



Built-in pump DMI Inside 208-...IN

Technical data

With automatic deaeration	<ul style="list-style-type: none"> • Especially suitable for violently degassing and crystallizing fluids (e.g. hydrogen peroxide or peracetic acid) • Not suitable for chlorine bleaching!
Accuracy	Dosing flow variation $\pm 1.5\%$, linearity $\pm 4\%$
Noise emission	approx. 45 dB(A), testing following DIN 45635-01-KL3
Max. suction height	6 m WC, for filled suction line and dosing head, continuous operation <i>Except 208-0.3: flooded suction!</i> these details refer to non degassing media with viscosity similar to water
Admission/backpressure	max. 0.2 bar admission pressure at suction side / min. 1 bar backpressure at pressure side
Max. viscosity	up to 200 mPa s (with automatic deaeration up to 50 mPa s)
Max. temperature	max. ambient temperature 40 °C
Parts in contact with media	PVC/Viton/glass, PVC/EPDM/ceramics, PP/Viton/glass, PVDF/PTFE/PTFE or stainless steel/PTFE/stainless steel; dosing diaphragm Viton /PTFE coated
Motor	Synchronous motor with gear reduction 230 V or 115 V, 50/60 Hz 11 W: for DMI model 208-0.3 / -1.0 / -1.6 / -3.0 / -4.0 / -5.0 22 W: for DMI model 208-0.8 / -1.1 / -3.6 / -6.0 / -9.0 / -14 / -18
Protection level	IP 65 (pump protection) <i>Except DMI model 208 Inside: IP 20</i>
Weight	approx. 2.9 kg / RAL 6017; except DMI model 208 Inside: approx. 1.5 kg

Connections

Pumps ≤ 10 bars

DMI 208-0.3 / -1.0 / -1.6 / -3.0 / -4.0 / -5.0 / -6.0	<ul style="list-style-type: none"> • suction side: PVC or PE hose 4/6, PVDF pipe 4/6, steel pipe 4/6 • pressure side: PE hose 4/6, PVDF pipe 4/6 <i>No PVC hose!</i>
DMI 208-0.9 / -14 / -18	<ul style="list-style-type: none"> • suction / pressure side: PVC hose 6/12, PP pipe 12/16 or PVDF pipe 14/16, steel pipe 1/4"

10 bars < pumps ≤ 16 bars

DMI 208-0.8 / -1.1 / -3.6	<ul style="list-style-type: none"> • suction side: PVC or PE hose 4/6, PVDF pipe 4/6, steel pipe 4/6 • pressure side: PVC hose 6/12, PP pipe 12/16 or PVDF pipe 14/16
----------------------------------	---

Functional drawing

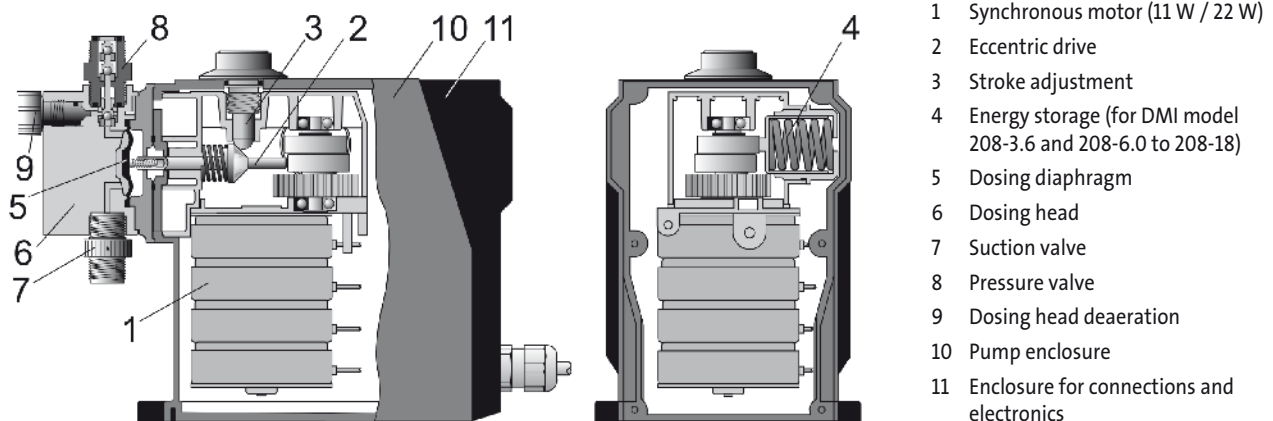

Dosing head and valve versions

Dosing head	Valve body	Material				Options: dosing head with			
		Seat	Gaskets	Valve ball ¹⁾		special valves		automatic deaeration valve ³⁾	diaphragm breakage indication
				4/6	6/12 12/16 14/16	spring-loaded pressure valve	set for viscous liquids ²⁾ >100 mPa s		

Dosing head with manual deaeration valve

PVC	PVC	Viton	Viton	glass	glass	✓	–	✓	✓
PVC	PVC	EPDM	EPDM	ceramics	PTFE	✓	✓	✓	✓
PP	PP	Viton	Viton	glass	glass	✓	–	–	✓
PP	PP	EPDM	EPDM	ceramics	PTFE	✓	✓	–	✓
PVDF	PVDF	PTFE	PTFE	ceramics	PTFE	✓	✓	–	✓
stainl. steel	stainl. steel	Viton	Viton	stainl. steel	stainl. steel	✓	✓	–	✓
stainl. steel	stainl. steel	PTFE	PTFE	stainl. steel	stainl. steel	✓	✓	–	✓

1) material depending on the connection size

2) suction and pressure side : spring-loaded valve with steel ball, connection 4/6 (208-0.3) or 6/12 (from 208-0.8);

DMI model 208-9.0/-18: suction side 9/12, pressure side 6/12

3) not for DMI model 208-0.3 and not for DMI model 208 Inside

Options

Mains voltage:

- 220-240 V, 50/60 Hz
- 110-120 V, 50/60 Hz
- 24 V, 50/60 Hz, not for 208-18IN

Mains plug / -cable

- Euro / 1.5 m
- Switzerland / 1.5 m
- without mains plug / 1.5 m

Electronics

- Diaphragm leakage indication
- Dosing controller



DMI P3

Optional electronics Etron

Contact signal and stroke frequency signal electronics

Electronics not available for DMI model 208 Inside!

Electronics without outputs

Etron	Input contacts N. O.
Unidos	Input contacts N. O.

Electronics with outputs

Etron, with multiplier /divisor	Outputs for error signal + pre-alert signal, contacts N. O.
	Outputs for error signal + stroke signal, contacts N. O.
	Outputs for error signal + pre-alert signal, contacts N. C.
	Outputs for error signal + stroke signal with Hall sensor, contacts N. O.
Unidos, contact signal 1:1	Outputs for error signal + stroke signal, contacts N. O.
	Outputs for error signal + stroke signal with Hall sensor, contacts N. O.

Accessories and armatures

(see separate Data Booklet Accessories)

Flow scheme of a complete dosing installation

- 1 Dosing tank 502
- 2 Electric agitator 509
- 3 Dosing pump DMI
- 4 Suction line 531 with empty signal
- 5 Pressure relief valve 525
- 6 Pulsation damper 517
- 7 Pressure loading valve 525
- 8 Injection unit 522

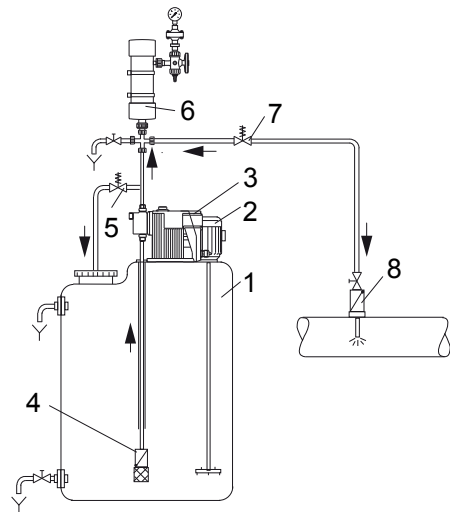

Transparent cover

- For dirt protection: optional for pumps with horizontal display

Description	Order number
Transparent cover (Makrolon)	553-1456

Wall console

- With fastening material

Description	Order number
PE black	539-006

Signal transmission

Description	Order number
-------------	--------------

Cable with plug, length 2 m

for contact input, analog signal input and remote On/Off	321-205
for outputs pre-alert / error signal and stroke signal	321-206

Cable with plug, length 5 m

for contact input, analog signal input and remote On/Off	321-207
for outputs pre-alert / error signal and stroke signal	321-208

Combined plug / cable for diaphragm leakage indication and dosing controller

combined plug 5 poles	321-210
cable 5 poles, length 5 m	321-223

Spare parts sets

- Suction and pressure valves (steel: only inner valve parts), gaskets for dosing head and valves, 1 deaeration cartridge, 1 dosing diaphragm, 4 screws for dosing head

Pump	Material	Order number
------	----------	--------------

Dosing head with manual deaeration valve

DMI 208-0.3 DMI 208-0.3 IN	PVC / Viton / glass	553-1395
	PVC / EPDM / ceramics	553-1399
	PVC / Viton / ceramics	553-1526
	PP / Viton / glass	553-1396
	PP / EPDM / ceramics	553-1400
	PP / Viton / ceramics	553-1693
	PVDF / PTFE / ceramics	553-1401
	Stainless steel / PTFE / st. steel	553-1402
DMI 208-0.8 to DMI 208-4.0 DMI 208-0.8 IN to DMI 208-4.0 IN	PVC / Viton / glass	553-1403
	PVC / EPDM / ceramics	553-1407
	PVC / Viton / ceramics	553-1597
	PP / Viton / glass	553-1404
	PP / EPDM / ceramics	553-1408
	PP / Viton / ceramics	553-1694
	PVDF / PTFE / ceramics	553-1409
	Stainless steel / PTFE / st. steel	553-1410
DMI 208-5.0 and DMI 208-6.0 DMI 208-5.0 IN and DMI 208-6.0 IN	PVC / Viton / glass	553-1411
	PVC / EPDM / ceramics	553-1415
	PVC / Viton / ceramics	553-1598
	PP / Viton / glass	553-1412
	PP / EPDM / ceramics	553-1416
	PP / Viton / ceramics	553-1695
	PVDF / PTFE / ceramics	553-1417
	Stainless steel / PTFE / st. steel	553-1418
DMI 208-9.0 to DMI 208-18 DMI 208-9.0 IN to DMI 208-18 IN	PVC / Viton / glass	553-1419
	PVC / EPDM / PTFE	553-1423
	PVC / Viton / ceramics	553-1708
	PP / Viton / glass	553-1420
	PP / EPDM / PTFE	553-1424
	PP / Viton / ceramics	553-1709
	PVDF / PTFE / PTFE	553-1425
	Stainless steel / PTFE / st. steel	553-1426

Dosing head with automatic deaeration valve

DMI 208-1.6 to DMI 208-4.0	PTFE / Viton / PTFE	10.8274-616
	PTFE / EPDM / PTFE	10.8274-615
DMI 208-5.0 and DMI 208-6.0	PTFE / Viton / PTFE	10.8274-616
	PTFE / EPDM / PTFE	10.8274-615
DMI 208-9.0 to DMI 208-18	PTFE / Viton / PTFE	10.8274-616
	PTFE / EPDM / PTFE	10.8274-615

96681612 0307	EN
15.820002 V6.0	

Subject to change.